

1017

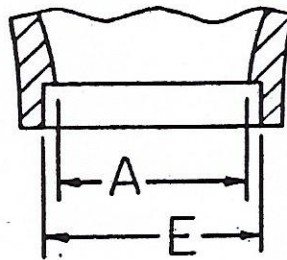

**MATERIALS**

1	Body	Steel, galv ASTM A216 WCB
2	Strainer Plate	Bronze ASTM B62
3	Screws	SS 18-8

A	B	C	D	E
1-1/2	4-1/2	4	4	1.92
2	4-1/2	4	4	2.41
2	5-1/2	5	4	2.41
2	6-3/4	6	5-1/2	2.41
2-1/2	5-1/2	5	4	NA
2-1/2	6-3/4	6	5-1/2	NA
3	6-3/4	6	5-1/2	3.54
6	11-3/4	11	12-3/4	6.72

**KINGS POINT MACHINERY, INC.**  
 9936 Gould Street  
 Oakland, CA 94603

(510) 638-2712  
 FAX (510) 638-3339

APPROVED

*Dev*

DATE

May 22, 2018

MODEL 1017 DECK DRAIN  
 Galv. Cast Steel Body  
 Socket Weld or Butt Weld

DRAWN BY

GRW

CHECKED BY

DCW

SCALE

NTS

DRAWING NO.

1017

REV.

SHEET

1 of 1