

KINGS POINT MACHINERY, INC.

NAVY DECK DRAINS – BUREAU OF SHIPS DWG. 810-1385789

TYPES A & A-1

With trap and valve.
TYPE A – 2" Seal
TYPE A-1 – 3" Seal

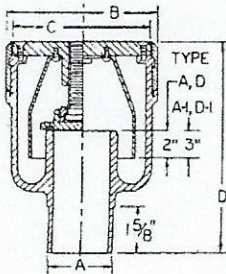

TYPES D & D-1

With trap, without valve.
TYPE D – 2" Seal
TYPE D-1 – 3" Seal

Male silbraz connection standard.
Bronze body with integrally cast steel welding sleeve. Bronze strainer plate, valve disc and nut. Monel valve stem. Brass baffle. Copper-nickel screws. Steel 'T' wrench available for 7/16" sq. socket in valve stem.

Specify size and type.

DIMENSIONS – INCHES

SIZE	A		B	C	2" SEAL		3" SEAL	
	Male	Female			D Male	D Female	D Male	D Female
1-1/2	1.900	1.905	5	4-19/32	8-5/16	6-13/16	9-5/16	7-13/16
2	2.375	2.380	5-9/16	5-5/32	8-21/32	7-21/32	9-21/32	8-7/32
2-1/2	2.875	2.882	6-5/8	6-5/32	8-15/16	7-5/8	9-15/16	8-5/8
3	3.500	3.507	7-5/8	7-3/32	9-3/8	8-1/8	10-3/8	9-1/8

TYPES G & G-1

With trap and valve.
TYPE G – 2" Seal
TYPE G-1 – 3" Seal

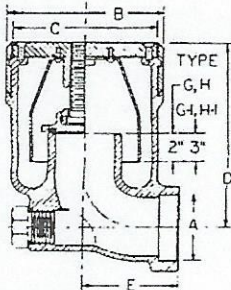

TYPES H & H-1

With trap, without valve.
TYPE H – 2" Seal
TYPE H-1 – 3" Seal

90° elbow with female silbraz connection.
Bronze body with integrally cast steel welding sleeve. Brass baffle. Bronze strainer plate, valve disc and nut, and cleanout plug. Monel valve stem. Copper-nickel screws. Steel 'T' wrench available for 7/16" sq. socket in valve stem.

Specify size and type.

DIMENSIONS – INCHES

SIZE	A	B	C	D		E
				2" Seal	3" Seal	
1-1/2	1.905	5	4-19/32	7	8	3-3/16
2	2.380	5-9/16	5-5/32	7-9/16	8-9/16	3-9/16
2-1/2	2.882	6-5/8	6-5/32	8-1/16	9-1/16	4-1/8
3	3.507	7-5/8	7-3/32	8-25/32	9-25/32	4-13/16

TYPE B

With valve, without trap.

Male silbraz connection.
Bronze body with integrally cast steel welding sleeve. Bronze strainer plate, valve disc and nut. Monel valve stem. Brass baffle. Copper-nickel screws. Steel 'T' wrench available for 7/16" sq. socket in valve stem.

Specify size and type.

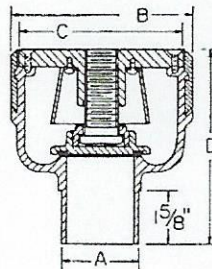

DIMENSIONS – INCHES

SIZE	A	B	C	D
1-1/2	1.900	5	4-19/32	5-9/16
2	2.375	5-9/16	5-5/32	5-29/32
2-1/2	2.875	6-5/8	6-5/32	6-3/16
3	3.500	7-5/8	7-3/32	6-5/8

TYPE C

Male silbraz connection.
Bronze body with integrally cast steel welding sleeve. Bronze strainer plate. Copper-nickel screws.

Specify size, type, and wooden or steel deck installation

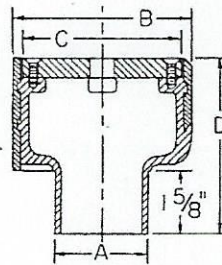

Style for wooden deck: at left in drawing.
Style for steel deck: at right in drawing.

DIMENSIONS – INCHES

SIZE	A	B	C	D
1-1/2	1.900	4	3-19/32	4-1/2
2	2.375	4-1/2	4-3/32	4-1/2
2-1/2	2.875	5-9/16	5-3/32	4-3/4
3	3.500	6-5/8	6-3/32	4-3/4

TYPE F

150 lb. flange connection.
Aluminum body, strainer plate and screws. Outlet flange drilled to MIL-F-20042.

Specify size and type.

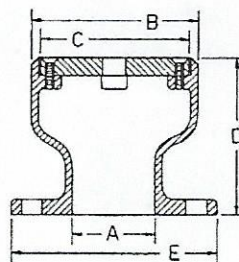

DIMENSIONS – INCHES

SIZE	A-MAX	B	C	D	E
1-1/2	1.770	4	3-19/32	4-9/32	5-1/16
2	2.240	4-1/2	4-3/32	4-11/32	5-9/16
2-1/2	2.750	5-9/16	5-3/32	4-5/8	6-1/8
3	3.370	6-5/8	6-3/32	5-5/16	6-5/8



Kings Point Machinery
9936 Gould Street
Oakland, CA 94603
Phone: (510) 638-2712
Fax: (510) 638-3339

Over 40 years of
Continued Growth
and
Customer Satisfaction